

Digital Anchor Point - UNC Thread Model No. 8-232

Main Features

- Rotates through 360° and pivot 180°, and simultaneously allows lifting from any direction
- Manufactured from forged alloy steel, quenched and tempered
- Tested in accordance with EN1677-1
- Load rated parts are 100 % magnaflux crack detected
- Individual forged parts and cap screw are traceable to Test Certification
- Bolts are UNC thread
- Proof tested to 2.5 times the WLL
- Fatigue rated to 20,000 cycles at 1.5 times the WLL
- All YOKE Lifting points meet or exceed all the requirements of ASME B30.26
- Quick and simple assembly, just a tapped hole is required

Certification:

Each unit comes fully certified with a test certificate or an EC Declaration of Conformity stating compliance with the essential health and safety requirements of the Machinery Directive 2006/42/EC, the Supply of Machinery (Safety) Regulations 2008 and Section 6 of the Health and Safety at Work Etc Act 1974.

Manufactured and tested in accordance with EN1677-1. All YOKE Lifting points meet or exceed all the requirements of ASME B30.26.

Technical Data

Product Code	Capacity (tonne)	Thread version			Dimensions (inch)											Torque in (Nm)	Net Weight (lbs)
		M (inch)	E (inch)	TPI	A	B	C	D	F	G	H	R	S	SW	I		
8-232-010	0.80	1/2	0.81	13UNC	1.30	1.55	1.20	0.41	3.16	2.29	0.91	0.67	5/16	3/4	1.72	100	0.6
8-232-020	1.60	5/8	1.14	11UNC	1.97	2.14	1.81	0.65	4.56	3.54	1.42	1.06	3/8	15/16	2.48	150	2.0
8-232-030	2.40	3/4	1.54	10UNC	2.01	2.06	1.89	0.65	4.56	3.54	1.44	1.06	1/2	1 1/8	2.46	250	2.1
8-232-038	3.00	7/8	1.42	9UNC	2.81	3.24	2.28	0.98	6.42	4.94	1.75	1.47	5/8	1 5/16	3.45	300	5.0
8-232-050	4.00	1	1.61	8UNC	2.81	3.18	2.34	0.98	6.42	4.94	1.75	1.47	5/8	1 1/2	3.45	400	3.4
8-232-078	6.25	1 1/4	2.09	7UNC	3.43	3.65	3.23	1.16	8.02	5.82	2.44	1.79	7/8	1 7/8	4.31	500	11.2
8-232-125	10.00	1 1/2	2.40	6UNC	4.29	4.38	4.05	1.42	9.92	7.40	3.11	2.22	1	2 1/4	5.04	800	22.3
8-232-200	16.00	2	2.99	4.5UNC	4.61	3.84	4.53	1.42	9.93	7.71	3.35	2.38	1 1/4	3	4.88	2000	28.7



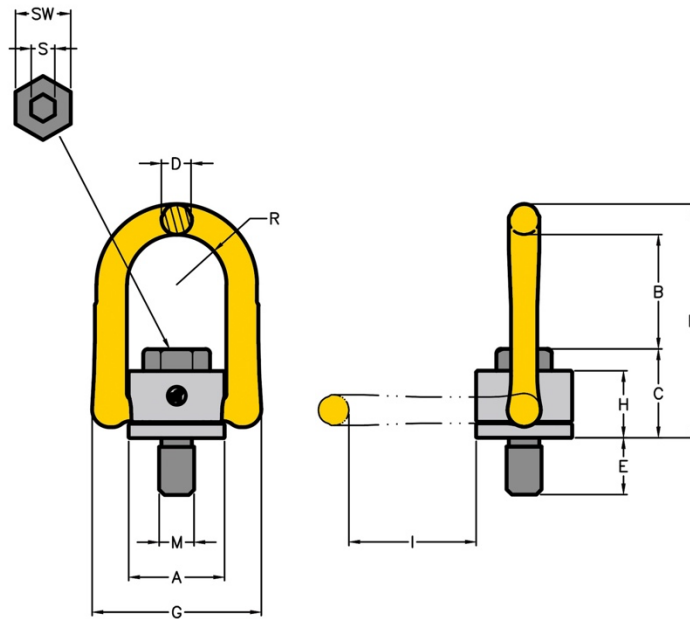

Kind of attachment											
Number of legs	1	2	1	2	2	2	2	3-4	3-4	3-4	
Load direction	0°	0°	90°	90°	0-45°	45°-60°	unsymm.	0-45°	45°-60°	unsymm.	
Product Code	WLL (t)										
Thread	WLL (t)										
8-232-010	1/2	1.2	2.4	0.80	1.6	1.12	0.80	0.80	1.68	1.20	0.80
8-232-020	5/8	2.6	5.2	1.60	3.2	2.24	1.60	1.60	3.36	2.40	1.60
8-232-030	3/4	3.6	7.2	2.40	4.8	3.36	2.40	2.40	5.04	3.60	2.40
8-232-038	7/8	4.5	9.0	3.00	6.0	4.20	3.00	3.00	6.30	4.50	3.00
8-232-050	1	7.2	14.4	4.00	8.0	5.60	4.00	4.00	8.40	6.00	4.00
8-232-078	1 1/4	9.6	19.2	6.25	12.5	8.75	6.25	6.25	13.13	9.38	6.25
8-232-125	1 1/2	11.0	22.0	10.00	20.0	14.00	10.00	10.00	21.00	15.00	10.00
8-232-200	2	16.0	32.0	16.00	32.0	22.40	16.00	16.00	33.60	24.00	16.00

Due to our policy of continual product development, dimensions, weights and specifications may change without prior notice. Please check with your GPS Lifting sales team when ordering.